

AAPA

Asian American
Psychological Association

August 1, 2012 ☀ Rosen Plaza Hotel ☀ Orlando, Florida

AAPA's 40th Anniversary:
**Broadening Scholarship
and Outreach**

AAPA President:
Richard M. Lee
Vice President:
Anna Lau



**Convention
Co-Chairs:**
Jocelyn Buhain &
Matthew Lee

Co-Sponsored by:

**The University of Central Florida's Counseling Center &
The American Psychological Association's Division 45:
Society for the Psychological Study of Ethnic Minority Issues**

Welcome to Orlando, FL and to the 2012 AAPA Convention!

Dear Convention Attendees:

Welcome to the 27th annual Asian American Psychological Association (AAPA) convention. Since 1985, AAPA has hosted a national convention to promote the best of Asian American psychological research, practice, and policy. This year is particularly noteworthy as it is also our 40th anniversary as a professional organization. Founded in 1972, AAPA is one of the oldest academic organizations dedicated to research and service to Asian American communities in the United States. As AAPA president, I am confident that our organization will continue to grow and expand its reach.

Fittingly, this year's convention theme is *Broadening Scholarship and Outreach*. Our convention co-chairs, Jocelyn Buhain and Matthew Lee, and all the program volunteers have put together an outstanding schedule featuring cutting-edge research, innovations in teaching and practice, and professional development activities. I sincerely hope you take advantage of all that AAPA has to offer during the convention and throughout the year and encourage you to find ways to contribute to our organization. The success of AAPA depends on the dedication and service of its members. Thank you and have a wonderful convention.

I look forward to seeing all of you again next year in Hawaii!

Aloha,



Richard M Lee, PhD, LP
AAPA President 2011-2013

Dear Students and Colleagues:

We are excited that you have joined us in celebrating AAPA's 40th anniversary. We have some wonderful events planned to highlight this momentous occasion in Asian American/Pacific Islander (AAPI) psychology. During our early bird reception, we will have a scavenger hunt that will encourage you to network and test your knowledge about AAPA. Our morning keynote panel consists of four past presidents who will share their stories about the organization's history and their wisdom on being influential leaders. Over the course of the day, you will have the opportunity to choose from 18 breakout sessions, join a special lunch discussion group, attend the poster session, and participate in the mentor-mentee networking reception. Don't forget to come to the afternoon Anniversary Celebration where we will have a special cake for AAPA's 40th! Finally, the day culminates with an evening banquet where we acknowledge our AAPA award recipients and crown this year's AAPA Idol winner in the post-meal karaoke competition.

This convention would not be possible without the hard work and dedication of the AAPA 2012 Convention Planning Committee. These individuals, students and professionals alike, have volunteered their time and energy toward making this occasion extremely special for all of us. So if you happen to cross paths with one of them, please take a moment to say "thank you."

We hope you rejuvenate your energy and passion towards life, professionally and personally, so that we all – as an AAPA family - can continue to flourish together. Happy 40th Anniversary AAPA!

Jocelyn Buhain and Matt Lee
AAPA 2012 Convention Co-Chairs

Thank you! Thank you! Thank you!

AAPA 2012 Convention Committee

Convention Co-Chairs: Jocelyn Buhain & Matt Lee
Banquet Co-Chairs: Kayi Hui & Sarah Yi
Book Drive Co-Chairs: Stephanie Lee & Alex Borgella
Mentor-Mentee Co-Chairs: Michelle Wang & Shihoko Hijioka
Poster Co-Chairs: Arpita Ghosh & Seung Yu
Program Co-Chairs: Ivy Ho & Catherine Hsieh
Registration Co-Chairs: Frances Shen & Ren Hong
Session Co-Chairs: Karen Cone-Uemura & Nicole Rider
Volunteer Co-Chairs: Simon Chung & Fanny Ng

Volunteers:

Masami Araki, Benjamin Au, Jennifer Chain, Wen-hsin Chang, Candy Chen, Jihee Cho, Na-Yeun Choi, Phillip Dang, Lavanya Devdas, Susi Ferradas, Gloria Huh, Kyoung Rae Jung, Shin-ye Kim, Monique Shah Kulkami, Yujia Lei, Chuck Liu, Priscilla Lui, Shruti Mukkamala, Joe Nee, Andrew Paves, Alefiyah Pishori, Nupur Sahai, Yuki Shigemoto, Sable Smith, My Linh Vo, Shannen Vong, Qianhui Zhang

Program Reviewers:

Haana Ali, Jacqueline Blue, Shayla Cashwell, Allan Chan, Chih-Ting Chang, Nadine Chang, Rachel Chang, Denise Choi, Sara Chung, EJ David, Michi Fu, Diane Hayashino, Yuhong He, George Hong, Valerie Jackson, Grace Kim, Monique Kulkarni, Maura Ladino, Liz Lee, Ren Li, Vanessa Li, Yashu Liang, Zeb Lim, Huiting Liu, Cristina Lorenz-Hansen, Jeff Mio, Jeanene Robinson-Kyles, Mariella Saavedra, Munyi Shea, Frances Shen, Pei-Chun Tsai, William Tsai, Meifen Wei, Chak Wong, Melinda Wong, Yisha Wu, Minji Yang, Jamie Young, & Yidan Zhang

Poster Session Judges:

Derek Kenji Iwamoto, Linda Juang, Grace Kim, Anna Lau, Matt Miller, Richard Shin, Nellie Tran, & Hyung Chol (Brandon) Yoo

Book Drive Sponsors: The following individuals and publishers donated items to the Book Drive: Blackwell Publishing, Edward C. Chang, Frank H. Wu, Information Age Publishing Inc., InterVarsity Press, Jeff S. Mio, John Wiley & Sons Inc., Karen L. Suyemoto, Pearson, Routledge, Taylor & Francis Group, Springer Publishing Company, Teachers College Press, & Temple University Press

AAPA Awards Committee: Gordon Nagayama Hall (Chair & Past AAPA President), Arpana Inman, John Moritsugu, & Donna Nagata

Dissertation Awards Committee:

Kevin Nadal (Chair), Asuncion Austria, EJ David, Helen H. Hsu, Brandon Yoo

Convention Details

Rosen Plaza Hotel
9700 International Drive, Orlando, FL 32819-8114
407.996.9700; www.rosenplaza.com

GETTING HERE

If you are Traveling by Car from Orlando International Airport:

- SR-528 or the Beachline Expressway (formerly the Bee Line Expressway) West toward International Drive, Turnpike & I-4
- Exit at International Drive SeaWorld, Convention Center Exit
- Turn Right onto International Drive
- The Rosen Plaza Hotel is located approximately one mile on the left, past the Convention Center, at 9700 International Drive

If you are Traveling by Car from Downtown Orlando or Florida Turnpike:

- I-4 West
- Exit at Sand Lake Road; turn left onto Sand Lake Road
- Turn right onto International Drive
- The Rosen Plaza Hotel is located approximately two miles on the right, at 9700 International Drive

Food throughout the Day and Dining Options:

AAPA will provide a continental breakfast and an afternoon snack break. For those individuals who ordered a box lunch, bring your lunch ticket and pick up your lunch in the alcove space located across from Salon 13. Other dining options at the Rosen Plaza Hotel include: Café Matisse (coffee house, grand buffet, & a la carte menu); Lite Bite (bakery, deli, package store, salads, and snacks); and Jack's Place (dinner selections feature seafood, steaks and pasta). There are additional eateries at Pointe Orlando located across the street from the Rosen Plaza Hotel.

Information regarding Continuing Education Credit:

The University of Central Florida Counseling Center has been approved as a continuing education provider by the Florida Board of Clinical Social Work, Marriage and Family Therapy, Mental Health Counseling and the Florida Board of Psychology. CE Broker Provider Number 50-5523.

If you are seeking continuing education credits for a specialty not listed above (including Licensed Psychologists from other States), it is your responsibility to contact your licensing/certification board directly to determine eligibility of this convention to meet your CE requirements.

2012 AAPA Convention Schedule
Convention Theme: "Broadening Scholarship and Outreach"

Registration & Breakfast: Opens at 7:30 AM
Mezzanine Foyer, Rosen Plaza Hotel
Early Bird Reception: 40th Anniversary Scavenger Hunt - Salon 11/12

Start your convention with good food and good company! Join a team and try to complete the 40th Anniversary Scavenger Hunt Contest. Special awards will be given to teams that answer all the questions.

Welcome and Announcements: 8:45 AM - 9:15 AM
Salon 11/12

Opening Remarks by Convention Co-Chairs, Dr. Jocelyn Buhain & Dr. Matthew Lee
Greetings by Dr. Richard M. Lee, President of AAPA
Greetings by Dr. Stacey Pearson-Wharton, Executive Director of Univ. of Central Florida Counseling Center
Announcements about the conference by Jocelyn Buhain

AAPA Keynote Panel: Exploring the History and Leadership of AAPA
9:15 AM - 10:45 AM
Salon 11/12

The Asian American Psychological Association (AAPA) was founded in 1972 by a group of Asian American psychologists and service professionals primarily based in the Bay Area. AAPA emerged to help improve psychological services to people from Asian descent and to serve as an organization for which professionals could meet, exchange ideas, bond to form relationships, and provide each other support. In celebration of 40 years as a thriving organization, we will be interviewing four past presidents of AAPA to intimately learn about its history and leaders. Our panelists are: Albert H. Yee, Ed.D., Nolan Zane, Ph.D., Christina Iijima Hall, Ph.D., and Karen Suyemoto, Ph.D. The moderator of this keynote session is Dr. Matthew Lee.

For more information:

Leong, F.T.L., & Okazaki, S. (2009). History of Asian American psychology. *Cultural Diversity and Ethnic Minority Psychology, 15*, 352-362. doi: 10.1037/a0016443

Tewari, N., & Alvarez, A.N. (Eds.) (2009). *Asian American psychology: Current perspectives*. New York: Taylor & Francis Group.

2012 AAPA Convention Sessions

Four sessions are eligible for 1.0 CE credit.

These sessions are marked with a * after the session title.

	11:00 – Noon	Lunch Discussions	1:15 – 2:15 PM	2:30 – 3:30 PM
Salon 11/12 Teaching & Training	Why Psychologists Should Be the Best Teachers in Any Field (but Aren't) *	Publishing in the Asian American Journal of Psychology	Teaching Asian American Psychology as Transformative Education*	Training Future Psychologists in Serving the Asian American Populations
Salon 13 Prevention & Outreach	From the Promise of Samosas to Hosting Bollywood Blowouts: Innovations in Reaching out to the South Asian Community*	Social Justice & Advocacy	Expanding Mental Health Outreach to API Communities in University and Community Settings	Conducting Community-Engaged Prevention/ Intervention Research Across the Lifespan
Salon 14 Clinical Concerns	Practice-Based Evidence Research Applied on Culturally Adapted Parenting Interventions among Asian Americans	Division of Students/ Early Career Professionals	Culturally Sensitive and Innovative Approaches for Chinese People with Severe and Persistent Mental Illness	Counseling Asian Americans: Past Research and Future Directions
Salon 15 Development Focus	Dissertation Award Symposium: 1. Unpacking the Relationship between Ethnic Identity and Adjustment among Biracials 2. The Role of Interpersonal Factors in Suicidal Ideation among Asian Americans and White Americans	Division on Women	Psychosocial Development of an Asian American in the United States and East Asia	Racial Identity Development: Applicability to Multiple Identity Development in Asian Americans and the Use of Family Narratives in Fostering Resiliency*
Salon 17 Stress-Related	Individual and Structural Level Race-Related Stressors among Diverse Asian Americans	Division of South Asian Americans	Cultural Influences on Stress, Coping, and Mental Health Symptoms: The ACES teen stress study	Racial Microaggressions Exist! Now...How Do They Impact Asian Americans
Salon 18 Special Topics	Broadening the Appeal of Asian American Psychology	Division on Filipino Americans	AAPA Leadership Fellows and the Challenge of Correcting Public Misinformation about Asian Americans	Sharing Wisdom: Vocational Journeys of AAPI Feminist Psychologists

SESSION ONE
11:00 AM – Noon

Salon 11/12

AAPA Invited Session - **Why Psychologists Should Be the Best Teachers in Any Field (but Aren't)**
Stephen Chew (Samford University) – 2011 U.S. Professor of the Year

Teachers base their pedagogy on a model of how students learn. Because psychologists know more about learning and cognition as well as other areas related to teaching than anyone else, we should be better teachers than those in any other field. Yet we often fail to link what we know to how we teach. We base instruction on untested assumptions that are subject to errors, biases, and misconceptions. I will discuss several lines of recent research that has explored issues that both students and teachers of psychology should address to improve learning. (1.0 CE)

Salon 13

From the Promise of Samosas to Hosting Bollywood Blowouts: Innovations in Reaching Out to the South Asian Community *Rahul Sharma (Illinois School of Professional Psychology), Razia Kosi, Ulash Thakore-Dunlap, Sushama Kirtikar*

Mental health professionals who are interested in addressing needs of the South Asian American community must find innovative ways to engage with the community. Given roadblocks to seeking therapy (e.g., culturally competent providers; cultural issues of shame/stigma; anomaly of psychotherapy), effective, innovative outreach measures are crucial. Panelists will share their experiences designing/implementing gender dialogues, hosting comedy shows, organizing book clubs, and screening films/discussions, highlighting struggles and triumphs in addressing the needs of the community. Attendees will have the opportunity to share their experiences and ideas in engaging South Asian communities taking into account culturally appropriate practices. (1.0 CE)

Salon 14

Practice-Based Evidence Research Applied on Culturally Adapted Parenting Interventions among Asian Americans *Alice W. Cheng (University of Hartford), Michi Fu (Alliant International University & Asian Pacific Family Center), Rocco Cheng & Terry Gock (Asian Pacific Family Center)*

A growing body of research supports the notion of utilizing practice-based evidence to bridge the gap that university-based research sometimes fails to address (Barkham & Hardy, 2010). Practice-based evidence study is demonstrated through an outcome study conducted between 2001-2005 using culturally-adapted parenting intervention from a community-based clinic in Southern California. The intervention improved parenting confidence, parenting skills and parent-child relationship. Results were consistent with community-based research on parent training on Chinese immigrant families (Lau, Fung, Ho, & Liu, 2011). The present study illustrated the importance of conducting community based study to increase applicability in real world settings.

Salon 15

Dissertation Award Symposium- Facilitated by Kevin Nadal

1) Unpacking the Relationship between Ethnic Identity and Adjustment among Biracials
Lauren Berger (Asian American Center on Disparities Research; University of California, Davis)

Understanding the biracial experience has become increasingly important as the U.S. biracial population has grown substantially in recent years. One integral aspect of the biracial experience is the conceptualization of one's ethnic identity, and its relationship to adjustment and mental health

outcomes. The goal in this study is to reconcile mixed findings in the literature by utilizing self-discrepancy theory and including social-psychological variables that might clarify under what conditions the ethnic identity of biracials is related to adjustment, and why it is related. A model will be tested using SEM to determine the paths from identity discrepancies to adjustment outcomes.

2) The Role of Interpersonal Factors in Suicidal Ideation among Asian Americans and White Americans *Janice Cheng (University of California, Davis)*

The interpersonal theory (Joiner, 2005; Van Orden et al., 2010) has proposed that perceived burdensomeness and thwarted belongingness are proximal and sufficient factors of suicidal ideation. Because of the cultural differences in interpersonal dynamics, it may not capture the important factors associated with suicidal ideation in Asian Americans. The current study aims to examine the effects of culturally related factors, namely perceived fulfillment of parental expectations and face concern, on suicidal ideation among Asian American and White college students. Empirical findings from this study will have important theoretical and applied implications for the understanding of suicidal ideation in Asian Americans.

Salon 17

Individual and Structural Level Race-Related Stressors among Diverse Asian Americans
Ivan Wu (Michigan State University), E. Tamim Mohammad (UMass, Boston), John Tawa (UMass, Boston), Fred Leong – Discussant (Michigan State University)

This symposium will provide a multi-level perspective to experiences of race-related stressors among various groups of Asian Americans at the individual and structural level by presenting three studies. The first study proposes an integrative model of stigmatization stress among Muslim Americans; the second study examines coping responses to racial harassment among Asian Americans; and the third study discusses resource competition among Blacks and Asians. The first two presentations will discuss race-related stressors at the individual level, whereas the third will address these issues at a structural level.

Salon 18

Broadening the Appeal of Asian American Psychology *Alicia Yee (University of Oregon), Gordon Hall (University of Oregon), Anna Lau, Nolan Zane*

The goal of this symposium is to share ideas about how to present Asian American psychology in a way that is meaningful and relevant to those outside of our area. The ability to do so will open up many opportunities for Asian American psychologists. Speaker 1 will focus on how to talk about research among colleagues and peers with different interests. Speaker 2 will focus on issues surrounding entering the job market with a relatively narrow specialty. Speaker 3 will address the challenge of obtaining grant money while studying Asian Americans, who are both perceived as a small and highly functioning population.

Please visit the Book Drive area & help raise funds to support our Student Travel Awards. Next year's convention will be in Hawaii!

Purchase a book for yourself or a colleague, a mug for a family member or friend, and a t-shirt to wear at the Thursday night 3rd annual AAPA GAMES!

LUNCH & NETWORKING
12:15 PM - 1:00 PM

Grab your lunch and join one of these exciting discussion groups. If you ordered a box lunch, please pick it up in the alcove across from Salon 13.

Salon 11/12	Publishing in the <i>Asian American Journal of Psychology</i>
Salon 13	Social Justice/Advocacy
Salon 14	Division of Students; Early Career Professionals
Salon 15	Division on Women
Salon 17	Division of South Asian Americans
Salon 18	Division on Filipino Americans

SESSION TWO
1:15 PM - 2:15 PM

Salon 11/12

Teaching Asian American Psychology as Transformative Education: Student Projects as Social Justice Change Initiatives to Address Racism and Institutional Inequity *Karen Suyemoto (UMass, Boston)*

Asian American Psychology courses can not only focus on imparting knowledge, but can also integrate Asian American Studies goals of fostering empowerment, activism, and implementing interventions to address Asian American students' needs and institutional inequities. This presentation overviews transformative education in relation to psychology and Asian American Studies and presents examples of an innovative approach to a semester project that meets simultaneous goals of imparting content knowledge about Asian American psychology; creating connections to students' lived experiences of race, culture, and systems of power; engaging issues of epistemology and opportunities for students to be producers of knowledge; and empowering students with the vision and skills to be social change agents. (1.0 CE)

Salon 13

Expanding Mental Health Outreach to API Communities in University and Community Settings *Natasha Olmos, Saeromi Kim, Stella Chow, Catherine Hsieh, Wendy Lin, and Edith Chung (all from UCLA Counseling and Psychological Services)*

In this interactive session, we will present strategies for consultation and outreach to API populations. Drawing from our experiences engaging with the API community in an urban university setting, we will discuss a model of outreach and consultation that can be applied to multiple and varied mental health settings. Most of the session will be spent in small groups where participants will have the opportunity to network and discuss with colleagues who work in similar clinical settings. Participants will be encouraged to develop at least one concrete action step that they can implement in their own work with API populations.

Salon 14

Culturally Sensitive and Innovative Approaches for Chinese People with Severe and Persistent Mental Illness *Angela Yeung – Symposium Chair, Angelina Maynard, Ginette Suk Ching Wong, & Kane Tung (Hamilton Madison House); Pei-Chen Hsu – Discussant (Hamilton Madison House)*

Personalized Recovery Oriented Services (PROS), a comprehensive recovery oriented program designed by the New York State Office of Mental Health for individuals with severe and persistent mental illness, was based on the Person-Centered Care model (Adams & Grieder, 2005). This symposium will include three presentations that focus on the innovative approaches utilized in this setting, which directly address challenges and barriers encountered when working with the Chinese population. The use of creative arts group interventions, video gaming, meditation, imagery and images will be discussed as approaches that have achieved initial success in providing support and safety for Chinese individuals.

Salon 15

Psychosocial Development of an Asian American in the United States and East Asia *Albert Yee (Former President of AAPA)*

Challenging aspirations, experiences, and reflection of individuals searching for meaning can shape psychosocial development that do not match Erik Erikson's pattern of fixed Eight Stages. Consider a fourth-generation Chinese American raised and educated in the SF Bay Area through a Stanford doctorate, whose contrasting, moving experiences impacted his situation and outlook -- in youth, as a Korean War GI, Oregon post-doc, Wisconsin-Madison professor, California and Montana academic dean, Fulbright Senior Lecturer at Tokyo University, Nixon 1972 China factor, Hong Kong professor with lecture tours in China, founder and developer of Macau's School of Education, Singapore dean, professor, etc.

Salon 17

Cultural Influences on Stress, Coping, and Mental Health Symptoms: The ACES teen stress study *Bahr Weiss (Vanderbilt Univ.), Lisa Liu & Hannah Nguyen (UCLA), Jennifer Manongdo (UC-Davis)*

Translational research on the role of cultural processes in shaping the outcomes of stress and coping may be instrumental in identifying strategies for how to best support healthy adaptation in diverse communities. Prospective research on stress and coping processes among adolescents is particularly informative as selective prevention efforts may be most efficient during this developmental period when risk of onset of affective disturbance increases. Asian American high school students are often presumed to be high achieving with few mental health needs, yet research suggests they are exposed to an array of distinctive stressors associated with the immigrant family context, high achievement expectations and peer discrimination. The overall purpose of the ACES teen stress study is to increase our understanding of how culture and cultural variation are related to manifestations of distress, with a particular focus on the “stress - coping -symptom manifestation” system.

Salon 18

AAPA Leadership Fellows and the Challenge of Correcting Public Misinformation about Asian Americans *Shihoko Hijioka (Casa Pacifica Centers for Children and Families), Nellie Tran (UMass Lowell)*

The 2011-2012 AAPA Leadership Fellows will present their work with Grace Kim, Sam Wan, Sumie Okazaki, and Joel Wong to create factsheets to correct misinformation on Asian American Bullying and Victimization and Asian American Suicide. Fellows will also reflect on their experiences of personal and professional development through the Fellows program and pass on this wisdom to other early career Asian American Psychologists. We will also engage the audience in a discussion about the needs of early career psychologists and sustaining the leadership pipeline in AAPA.

SESSION THREE
2:30 PM - 3:30 PM

Salon 11/12

Training Future Psychologists in Serving the Asian American Populations *Pei-Chen Hsu (Hamilton-Madison House), Daniel Kaplan (College of Staten Island of the City University of New York), Pei-Wen Winnie Ma (William Paterson University), Xiang Zhou (New York University), Hsin-Hua Cynthia Lin (Brooklyn College of the City University of New York)*

There is a severe shortage of culturally competent mental health professionals to serve the Asian American population. One solution for this problem is to provide a specialized training program to prepare psychology interns to serve the Asian community. The proposed session will review the significance of this problem; evaluate an internship designed for this purpose; and invite session participants to discuss the training directions for similar internship programs and other solutions to retain and increase the number of bilingual Asian psychologists in serving the Asian American community.

Salon 13

Conducting Community-Engaged Prevention/Intervention Research Across the Lifespan *Richard M. Lee (University of Minnesota), Lovey Walker (University of Minnesota), Moin Syed (University of Minnesota), Anita Patel (YWCA), Anna Marie Vu (University of Minnesota), Belle Khuu (University of Minnesota), Matthew Miller (University of Maryland), Na-Yeun Choi (University of Maryland), Minji Yang (University of Maryland), Gloria Huh (University of Maryland), Hweon Seo (University of Maryland), Victoria Ngo (RAND Corporation)*

This symposium will highlight different ways in which researchers, clinicians, and agencies can work together to design, adapt, implement, and evaluate prevention and intervention programs that address mental health service disparities. Each presenter will provide an overview of their community-engaged research projects, including preliminary findings, but will spend an equal amount of time discussing lessons learned working with community partners and populations. The discussant will address how to develop clinical training capacity for the implementation of evidence-based prevention and intervention programs. Ample time will be allotted for audience discussion on learning how to conduct community-engaged prevention and intervention research.

Salon 14

Counseling Asian Americans: Past Research and Future Directions
Arpita Ghosh (University of Wisconsin-Milwaukee), Shin-ye Kim, Wen-hsin Chang

With a projected rise of the Asian American population in the United States, it is important for clinicians and other providers to consider the contextual factors that are specific to this group. Previous research has highlighted variables, such as acculturation and family influence, which are unique to this group that must be considered during therapy sessions. This interactive session will provide participants with a brief overview of previous literature on contextual factors that influence therapy, discuss gaps in current clinical practices, and identify other variables clinicians working with this group must consider to provide effective and multiculturally competent services. The three doctoral student facilitators will introduce the topic and provide a forum for discussion among participants to share their work with this population and develop ideas for culturally appropriate treatments.

Salon 15

Racial Identity Development: Applicability to Multiple Identity Development in Asian Americans and the Use of Family Narratives in Fostering Resiliency *Robin Li (South Shore Mental Health), G. Nicole Rider (Howard University), Lou Felipe (Santa Clara University), Susana Ferradas (Howard University)*

This symposium aims to compare and contrast existing racial socialization theories, the applicability of these theories to Asian Americans, and how narratives within the family context contribute to racial identity development. Specific objectives will be to recognize the need for continued refinement of existing racial identity development theories, discuss how narratives have facilitated personal identity development, and recognizing new directions for research and practice. (1.0 CE)

Salon 17

Racial Microaggressions Exist! Now...How Do They Impact Asian Americans *Gloria Wong (UC-Davis), Yinglee Wong (John Jay College of Criminal Justice-CUNY), Kevin Nadal (John Jay College of Criminal Justice-CUNY), Nolan Zane – Discussant (UC-Davis)*

In this seemingly post-racist era, race-related stress and racial discrimination are still affecting People of Color. There has been a shift from more overt forms of racism to more subtle, insidious forms of discrimination— researchers have termed this more subtle, often unintentional version of discrimination as racial microaggressions (Pierce, Carew, Pierce, Gonzalez, and Willis, 1978; Sue, 2010). Racial microaggressions are brief and subtle forms of behavioral and verbal discrimination towards people of color. This symposium will present quantitative, qualitative, and experimental studies on the impact of racial microaggressions on psychological and physical health outcomes among Asian Americans.

Salon 18

Sharing Wisdom: Vocational Journeys of AAPI Feminist Psychologists *Catherine Hsieh (University of Missouri), Nellie Tran (UMass Lowell), Bonny Chang (Texas A&M University), Jean Lau Chin (Adelphi University), Khanh Dinh (UMass Lowell), Debra Kawahara (CSPP at Alliant International University), Phi Loan Le (Santa Ana College), Karen Suyemoto (UMass Boston)*

A career in psychology today for Asian American Pacific Islander (AAPI) women includes a wide range of professional opportunities in research, practice, teaching, training, consulting, service, and leadership across a variety of settings. The many professional pursuits of AAPI feminist psychologists can be challenging without the guidance of role models or mentors who understand the complexity of AAPI women career development. In this interactive session, a panel of seasoned AAPI feminist psychologists will share their career development journeys as leaders, psychologists, advocates, and mentors. The goal of the session is to expand participants' knowledge of career development issues unique to AAPI feminist psychologists through the sharing of experiential knowledge of AAPI feminist leaders in psychology.

Would you like to help plan the 2013 AAPA Convention in Hawaii?
Please contact Convention Co-Chair, Matt Lee
(leemr@jmu.edu) regarding your interest.

POSTER SESSION: 3:30 PM – 4:30 PM
Mezzanine Foyer

1. Anti-Stigma Intervention for Chinese Relatives of Individuals with Psychosis: A Pilot Study
Grace Ying-Chi Lai (New York Univ.), Ming Tu (Columbia Univ.), Vanessa Li (Columbia Univ.), Shuchang Kang (Columbia Univ.), Annie Liang (Columbia Univ.), Shijing Jiang (Columbia Univ.), Dawn Sung, Yisha Wu (Columbia Univ.), & Lawrence Yang (Columbia Univ.)
2. Asian American Clients' Use of Complementary and Alternative Medicine
Tai Chang, Eddie Chiu, & Nicole Mayeda (all poster authors from CSPP, Alliant International Univ.)
3. Breaking the Boundaries of Stigma against Chinese Immigrants with Mental Illness
Rachel Chang, Melinda Wong, Ming-Che Tu, Vanessa A. Li, Diana Han
4. Chinese International Students' Mental Health: Impact of Stereotype Threat and Perceived Discrimination
Jennifer Chain, Gordon Hall, & Alisia Caban (all poster authors from Univ. of Oregon)
5. Creative Arts Mental Health Intervention for Chinese American Individuals with Severe and Persistent Mental Illness
Jennifer Tam (CSPP, Alliant International Univ.), Pei Chen Hsu (Hamilton-Madison House), & Angela Yeung (Hamilton-Madison House)
6. Cultural Values and Stigma Predicting Asian Americans' Attitude toward Seeking Professional Psychological Help
Na-Yeun Choi (Univ. of Maryland) & Matthew J. Miller (Univ. of Maryland)
7. Examining the Stigma Experiences of Chinese Immigrant Families of Individuals with Severe Mental Illness: Implications for Intervention
Ren Li (Teachers College, Columbia Univ.), Rachel Chang, & Sara Chung
8. "Face" and the Manifestation of Stigma among Chinese Immigrants with Schizophrenia
Nina Huynh (Columbia Univ., Mailman School of Public Health), Kara Morita, Kristy Nguyen, Mariella Saavedra, & Sara Chung
9. Familial Contributions to Education and Success of Asian-Americans
Hollis Tsoi, Joe Nee, & Michi Fu (all poster authors from Department of Clinical Psychology, Alliant International Univ.)
10. Hmong Parents' Day: Hosting a Campus Event for Community Advancement
Pa Her, Shee Yee Chang, Pahoua Thao, Ker Thao, Alberta M. Gloria, Maimoua Xiong, Saengthong Douangdara, Michelle Xiong, & Hnub Vang (all poster authors from University of Wisconsin-Madison)
11. Impact of Asian Values and Experiences of Discrimination on Internalized Homo-Negativity and Well-Being among Asian American LGBT
Frances Shen, Rebecca Goldsborough, & Brittany Sievers (all poster authors from Univ. of Illinois-Springfield)

12. Interpersonal Harmony as Moderator of the Link between Suppression and Anxiety among Chinese and European American College Students
Hui-Hsun Lai (National Taiwan Univ.), Jenny Chen-Yi Su (National Taiwan Univ.), Meifen Wei (Iowa State Univ.), Shu-Ping Lin (Tamkang Univ.), & Hsiao-Tien Tsai (National Taiwan Univ.)
13. Labeling as a Source of Stigma in Chinese Schizophrenia Patients
Chak Wong (Columbia University), Maura Ladino, Shayla Cashwell, Kara Morita, Nina Huynh, & Yimin Fan
14. Language-Related Predictors for Family Support and Cohesiveness among Asian American Adults in the National Latino and Asian American Study
Sharon Hsin Hsu (Department of Psychology, Univ. of Washington), Yangqing Wang (Department of Psychology, Univ. of Washington), Taylor William Boren (Department of Psychology, Univ. of Washington), & David Takeuchi (Department of Social Work, Univ. of Washington)
15. Learning New Things from Familiar FACES: Examining Alcohol Expectancies among Filipino Americans
Andrew Paves, Kathryn Alcid, Amanda Gilmore, Hollie Granato, Hong Nguyen, & Mary Larimer (all poster authors from University of Washington)
16. Obesity among Korean Americans: Using Information Motivation Behavioral Skills Model to Understand Rising Obesity across Generation
Denise Choi (The Graduate Center, The City University of New York)
17. Predictors of Corporal Punishment Attitudes for African, Asian, Latino, and White American Students
Phillip Akutsu (California State Univ., Sacramento), Bahareh Abhari (Univ. of California, Davis), Ho Man Cheung (California State Univ., Sacramento), & E-Ting Lee (California State Univ., Sacramento)
18. South Asian Americans: A Three Decade Content Analysis
Arpana G. Inman, Lavanya Devdas, Asmita Pendse, & Valeriya G. Spektor (all poster authors from Counseling Psychology, Lehigh University)
19. Suppression and Depressive Symptoms among Taiwanese and European American College Students: The Mediating Role of Authenticity and Interpersonal Friction
Hsiao-Tien Tsai (National Taiwan Univ.), Jenny Chen-Yi Su (National Taiwan Univ.) Meifen Wei, (Iowa State Univ.), Shu-Ping Lin (Tamkang Univ.), & Hui-Hsun Lai (National Chung Cheng Univ.)
20. The Immigrant Paradox among Asian American Women
William Tsai (University of California, Los Angeles) & Anna Lau (University of California, Los Angeles)
21. The Impact of Cultural Matching between Mental Health Consults and Chinese Immigrant Children and their Families
Yuki Okubo (California School of Professional Psychology at Alliant International University), Rose Sneed (Fu Yau Project at RAMS), Jacqueline Nguyen, Lei Chen, Cheuk-Shan Alex Kuang, Kavoos Bassiri, Christina Shea, Angela Tang, & Janette Liu
22. The Influence of Perceived Social Support on the Relationship between Acculturation and Subjective Well-being among Asian Indians
Monika Parikh (Washington State University)

23. The Mediating Role of Cognitive Emotion Regulation in the Relation between Contingent Self-Worth and Psychological Functioning
Chien-Han Kao (National Taiwan Univ.), Jenny Chen-Yi Su, (National Taiwan Univ.), Ding-Yu Jiang (National Chung Cheng Univ.), Woei-Haur Lin (National Taiwan Univ.), & Shu-Ping Lin (Tamkang University)
24. The Mental Health Effects of Multiple Minority Statuses for Asian American Women
Shruti Mukkamala (Univ. of Massachusetts, Boston) & Karen L. Suyemoto (Univ. of Massachusetts, Boston)
25. The Relationship between Acculturation, Help Seeking Attitudes, and Professional Utilization Behavior among Asian Indians
Reema Beri (Illinois Institute of Technology) & Tamara Goldman Sher (Northwestern University)
26. The Satisfaction with Parental Upbringing Scale
Noriel E. Lim (Emory University School of Medicine) & Sumie Okazaki (New York Univeristy)
27. Using an Asian American Animated Agent to Treat the Irrational Career Beliefs of Chinese American Young Females
Xue Zhang (Arizona State University)
28. Westernization and its Effects on Relative Caregivers of Chinese Immigrants with Schizophrenia
Kristy Nguyen, Ming Tu, Vanessa Li, Huiting Liu, & Ren Li (all poster authors from Teachers College, Columbia University)

40th Anniversary Cake Celebration: 4:30 PM – 4:45 PM

Join us for drinks and desserts in the alcove across from Salon 13 as we celebrate AAPA's 40th Anniversary.

MENTOR-MENTEE RECEPTION

4:45 PM – 5:45 PM

Salon 11/12

This is an exciting opportunity for Asian American students and early career professionals to network with more experienced professionals. Using a semi-structured format, students and professionals are initially matched according to similar topics of interests as indicated on the registration questionnaire. Mentors will remain at a designated professional development topic area, while mentees will be able to alternate topics as they choose to meet their needs.

Closing Remarks

5:45 PM – 6:15 PM

Salon 11/12

Presentation of the following awards: 2012 Best Poster Award, Student Travel Awards, Division of Women Awards, Division of South Asian Americans Award, and the 2011 AAJP Best Paper Award: "Family, School,

and Neighborhood: Links to Chinese American Adolescent Perceptions of Racial/Ethnic Discrimination" authored by Linda Juang and Alvin Alvarez.

In addition, we will recognize AAPA's Outgoing and Incoming AAPA Officers.

Thank you to our outgoing officers:

Christina Lee (Secretary/Historian), Kevin Nadal (Board of Directors-Professional Member), Judy Tan (Board of Directors-Student Member)

Welcome to our incoming officers:

Sumie Okazaki (President-Elect), Linda Juang (Secretary/Historian) Cindy Hsin-Ju Liu (Board of Directors-Professional Member), Zeb Lim (Board of Directors-Student Member)

AAPA AWARDS BANQUET
7:00 PM - 10:00 PM
Ming Court Restaurant

*NOTE: Please make sure to bring your banquet ticket.

The banquet will be held next door to the Rosen Plaza Hotel at the Ming Court Restaurant, 9188 International Drive, Orlando, FL. We will be presenting the following awards:

2012 Dissertation Research Award Recipient: Oh Myo Kim (University of Minnesota)

Dissertation Title: "Writing the Unknown: An Expressive Writing Intervention for Adopted Korean American Adults"

Two Honorable Mentions:

Gregory Gonzaga Desierto, Dissertation Title: "Kumibo Ka Naman Diyan: Childhood Sexual Abuse Disclosures of Filipino American Men"

Alan Ka Ki Chan, Dissertation Title: "Consensus in Social Norms and Gambling Behavior"

2012 AAPA Fellow: Wei-Chin Hwang, PhD (Claremont McKenna College)

2012 Early Career Award: Y Joel Wong, PhD (Indiana University Bloomington)

2012 Presidential Awards: Larke Nahme Huang and Xiaojia Ge (posthumous)

Special Event: 3rd Annual AAPA Games
Thursday, August 2nd from 6-8 PM
Orlando Sports Center
6700 Kingspointe Parkway, Orlando, FL 32819

Join us for the Free Throw Contest and 3-Point Shootout. Then watch and cheer for your team during the Faculty vs. Student Basketball Game. When you arrive, please ask the front desk for the reservation under AAPA/Nolan Zane. Don't forget to wear your AAPA T-shirt!

Transportation: The Sports Center is about 4.5 miles from the Orange County Convention Center. Yellow cab said it takes about 10 minutes (15 minutes tops) to get there because of traffic. One-way fare will be approximately \$13.00

2012-13 Asian American Psychological Association Executive Board

President

Richard M. Lee, Ph.D.

Vice President

Anna Lau, Ph.D.

President Elect

Sumie Okazaki, Ph.D.

Finance

Richard Shin, Ph.D.

Membership

Frances Shen, Ph.D.

Communications Officer

Ulash Dunlap-Thakore, Ph.D.

Secretary/Historian

Linda Juang, Ph.D.

Delegate to APA Council

Alvin Alvarez, Ph.D.

Board of Directors

Richelle Concepcion, Ed.D.

Grace Kim, Ph.D.

Cindy Hsin-Ju Liu

My Linh Vo (Student Rep.)

Asian American Journal of Psychology Editor

Frederick T.L. Leong, Ph.D.

AAPA Past Presidents

Derald W. Sue	1972 - 1974
Robert Chin	1975 - 1976
Albert Yee	1979 - 1982
Harry Yamaguchi	1982 - 1984
Herbert Wong	1984 - 1988
Katsuyuki Sakamoto	1988 - 1990
David Goh	1990 - 1991
Nolan Zane	1991 - 1993
S. Andrew Chen	1993 - 1995
Christine Iijima Hall	1995 - 1997
Reiko Homma True	1997 - 1999
Gayle Iwamasa	1999 - 2001
Jun-Chih Gisela Lin	2001 - 2003
Frederick T. L. Leong	2003 - 2005
Alvin N. Alvarez	2005 - 2008
Karen L. Suyemoto	2008 - 2010
Gordon Hall	2010 - 2011
Richard M. Lee	2011 - Present

MEZZANINE LEVEL

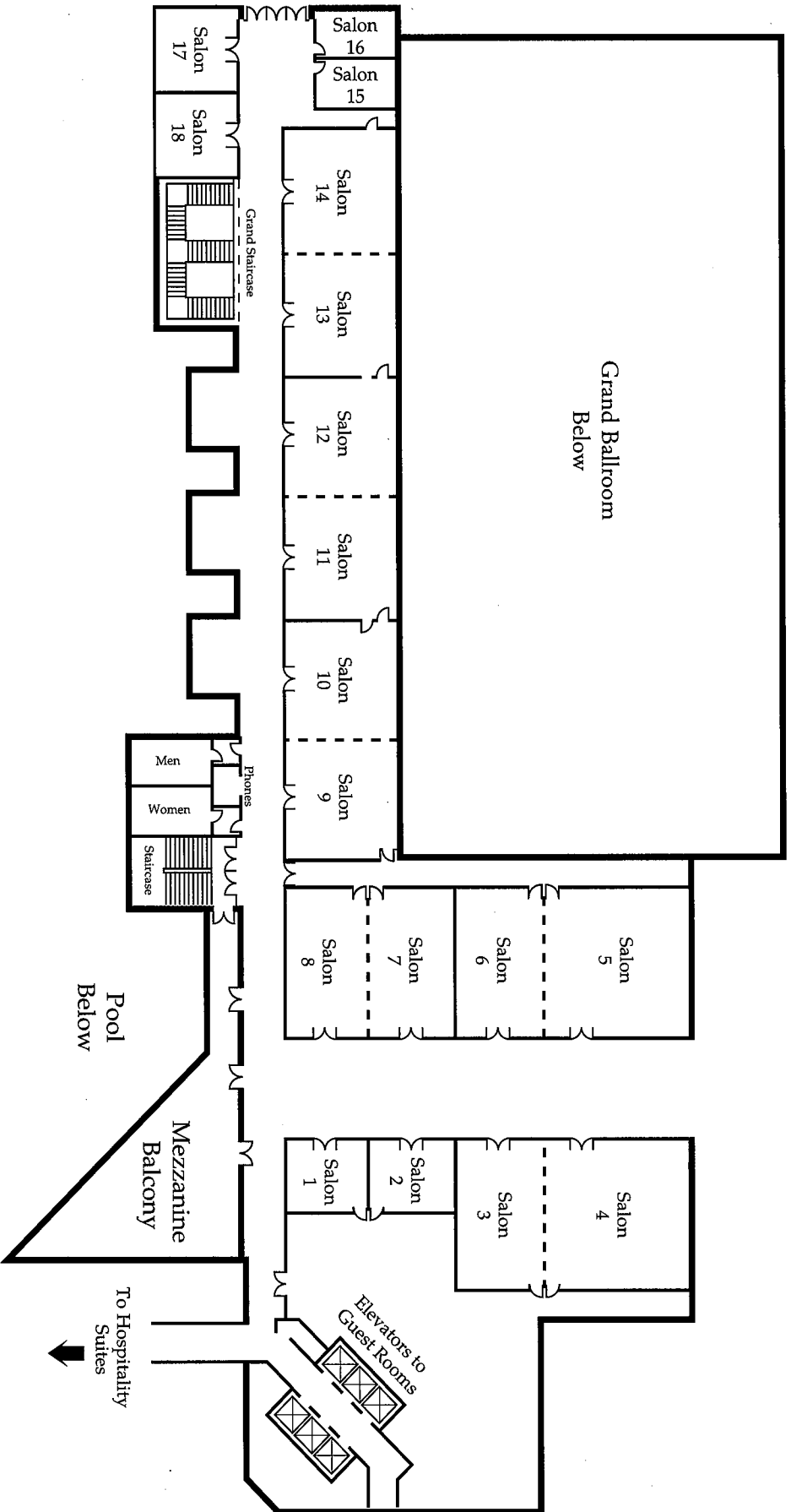

THE ROSEN
HOTEL
PLAZA

9700 International Drive • Orlando, FL 32819
 800-627-8258
 407-996-9700 • Fax 407-996-9111
 www.rosenplaza.com